

| Rev | Description  | By | Date      |
|-----|--|----|-----------|
| 1   | Preliminary  | CF | 26-Feb-18 |
| 2   | Removed stripping and extended bottom lead to 80mm | SO | 3-Aug-22  |

**Base**

305-250075-210-12

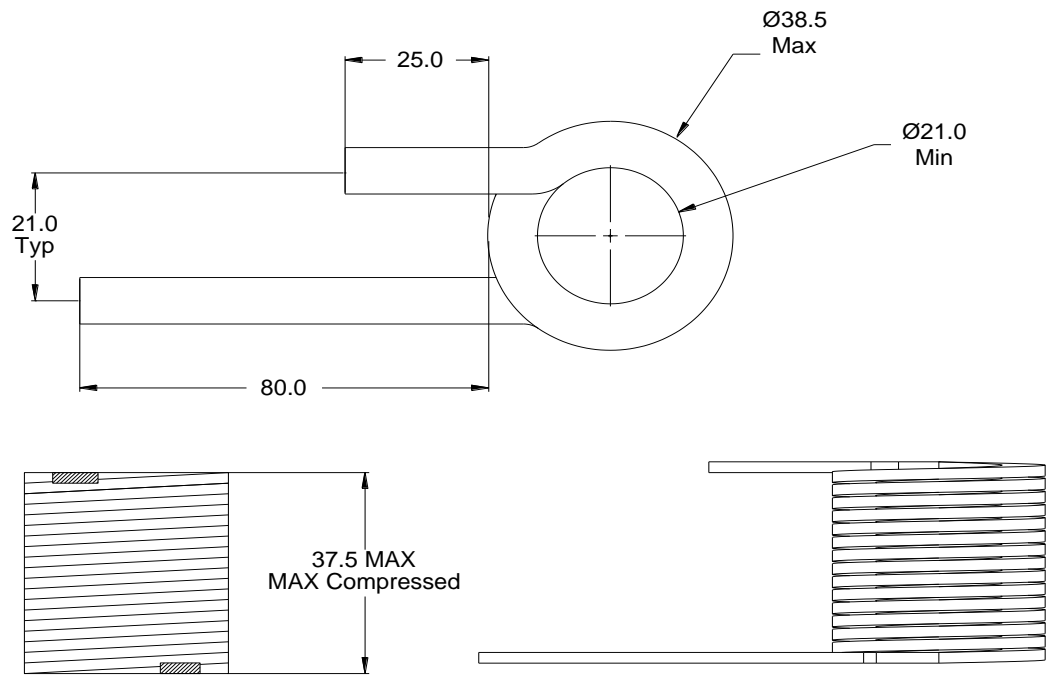

Dimensions: mm

Base Materials: [2.50mm x 7.50mm Wire](#)

DCR:  
 Turns Number: 12T  
 Insulation Class: Class K MIN, 200°C  
 RoHS Compliant: Yes

**Notice of Proprietary Property**  
 These drawings and specifications are the property of MPS and shall not be, reproduced, copied or used as the basis of manufacture of sale of apparatus without express written authorization

|   |                          |           |                       |                  |
|---|--------------------------|-----------|-----------------------|------------------|
| <b>Dimensions</b><br>Unless otherwise specified<br>.XX ± .010" [0,254mm]<br>.XXX ± .005" [0,13mm] | DRAWN BY:<br>CHECKED BY: | MIG<br>SO | 19-Oct-15<br>3-Aug-22 | SIZE<br><b>A</b> |
|---|--------------------------|-----------|-----------------------|------------------|

**MPS INDUSTRIES, INC.**  
[www.mpsind.com](http://www.mpsind.com)  
 Tel: (310) 325-1043 Fax: (310) 325-1044

Description  
**HEW Coil 2.50 mm x 7.50 mm Ø 21.0 mm 12 Turns**

|   |                 |
|---|-----------------|
| Part Number<br><b>305-250075-210-12</b> | REV<br><b>2</b> |
| WEIGHT: XX gms SHEET: 1 OF 1            |                 |